



**first  
national**  
REAL ESTATE

| Gerard Smith



### 28 Station Street Douglas Park NSW

4 2 2

Discover the epitome of modern family living in this immaculate 6-year-old residence, nestled in the heart of Douglas Park. Boasting a perfect blend of contemporary design and timeless appeal, this home is tailored to meet the needs of today's discerning buyers who value space, style, and comfort.

From the moment you enter, the home exudes warmth and sophistication, highlighted by the stunning hybrid timber flooring that spans the entire living space. The open-plan layout creates an inviting atmosphere, where the living, dining, and kitchen areas converge seamlessly. This design not only enhances the sense of space but also facilitates effortless entertaining and family interactions.

**Type** : House  
**Price** : Price Guide \$1,050,000  
**Land Size** : 785.7 sqm  
**View** : <https://www.gerardsmith.com.au/8108827>



**Paul Vella**  
04 9090 4396

[For full version visit the website](https://www.gerardsmith.com.au)

<https://www.gerardsmith.com.au>

0246771488

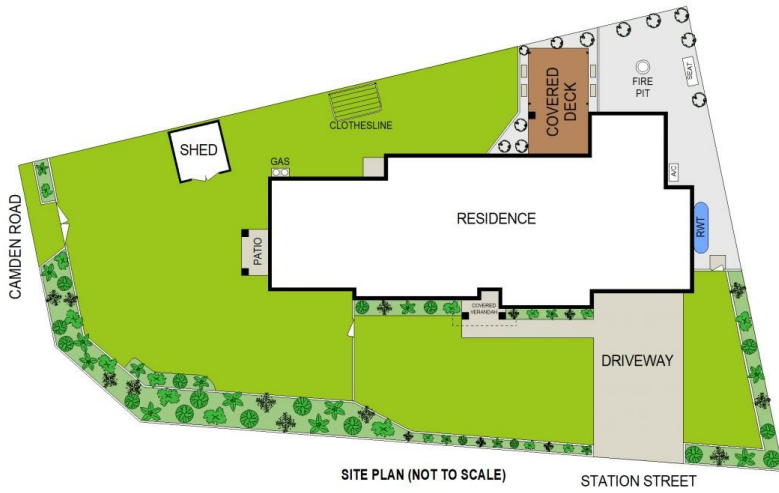

Scale in metres. Indicative only. Dimensions are approximate. All information contained herein is gathered from sources we believe to be reliable. However we cannot guarantee its accuracy and interested persons should rely on their own e

28 Station Street, Douglas Park

